

7030 - Metric Adaptor x BSP Female

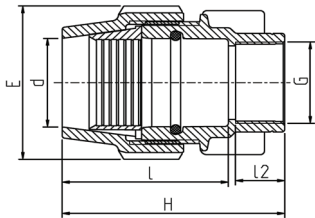

d (mm)	G (mm)	Part No.	H (mm)	E (mm)	I (mm)	I2 (mm)	Weight (g)	Price \$
16	1/2"	PCF-AF-16-15	73	39	52	19	36	7.77
20	1/2"	PCF-AF-20-15	82	48	60	19	60	8.05
20	3/8"	PCF-AF-20-20	82	48	60	19	58	8.05
20	1"	PCF-AF-20-25	92	48	57	21	68	8.05
25	3/4"	PCF-AF-25-20	88	54	63	21	83	9.34
25	1"	PCF-AF-25-25	88	54	63	21	78	8.30
32	1"	PCF-AF-32-25	94	64	69	21	115	11.19
32	1 1/4"	PCF-AF-32-32	96	64	67	25	140	16.09
40	1"	PCF-AF-40-25	112	82	84	21	178	16.09
40	1 1/2"	PCF-AF-40-40	114	82	84	25	225	16.09
50	1 1/2"	PCF-AF-50-40	123	96	93	25	276	21.74
50	2"	PCF-AF-50-50	128	96	93	30	293	21.74
75	2"	PCF-AF-75-50	175	132	132	30	662	72.00
90	2"	PCF-AF-90-50	213	154	183	30	1137.9	107.01
90	3"	PCF-AF-90-75	223	154	183	40	1204	107.01
110	3"	PCF-AF-110-75	261	181	213	40	1915	199.92
110	4"	PCF-AF-110-100	271	181	213	50	2048	199.92

Price Group: SD
MS01

7035 - Metric Mine Adaptor x BSP Female



d (mm)	G (mm)	Part No.	H (mm)	E (mm)	I (mm)	I2 (mm)	Weight (g)	Price \$
63		PCF-AF-63-50	148	113	110	30	442	39.91

Price Group: SD
MS01

7220 - Metric Flanged x Adaptors

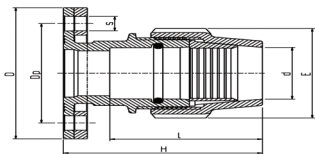

d (mm)	DN (TE)	Part No.	D (mm)	H (mm)	Dp (mm)	E (mm)	I (mm)	S (mm)	Weight (g)	Price \$
50	2"	PCF-AFL-50-50	165	128	125	96	93	18	1507	93.42
63	2 1/2"	PCF-AFL-50-63	165	145	125	113	110	18	1559	93.42
75	3"	PCF-AFL-75-75	185	164	145	134	152	18	2089	135.78
90	4"	PCF-AFL-90-100	220	195	180	154	183	18	3161	155.57
110	4"	PCF-AFL-110-100	220	235	180	181	222	18	3322	181.79

Price Group: SD
MS01

7225 - Metric Mine Flanged x Adaptors



d (mm)	DN (TE)	Part No.	D (mm)	H (mm)	Dp (mm)	E (mm)	I (mm)	S (mm)	Weight (g)	Price \$
63	2 1/2"	PCF-AFL-63-63	165	145	125	113	110	18	1559	108.45

Price Group: SD
MS01